

AFTER CARE:

To maintain the appearance of this tap, ensure that it is regularly cleaned only using a clean, soft damp cloth. A solution of warm water and a mild liquid detergent may be used where necessary, and then the fitting rinsed thoroughly and wiped dry. Abrasive cleaners, scouring cleaners and acid cleaners **must not be used** under any circumstances. All bath cleaning powders and liquids will damage the surface of your fitting even the non-scratch cleaners. Avoid contact with all solvents and any harsh household chemicals. You will damage the plated finish and void your guarantee.

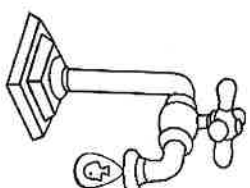

sammartaps.com

GUARANTEE AND LIABILITY

In the unlikely event that you should experience any defect in the material or workmanship of your mixer tap within 2 years of purchase, we will replace the faulty part free of charge. Decorative surface finishes and valves are guaranteed for one year from the date of purchase provided that our advise concerning care has been observed and no scouring agents have been used. This is provided that the mixer or tap has been used for normal domestic purposes in the UK and that the care, installation and maintenance instructions have been observed. Scuff and scratches caused by normal wear and tear, improper installation or accidental damage are excluded from this guarantee. You should retain a copy of your dated invoice as proof of purchase to validate any claims under this guarantee. No other warranties, express or implied, are made, including merchantability or fitness for a particular purpose.

SPARE PARTS AND SERVICE

Contact **HIGHWAY WHOLESALERS LTD**
Phone 051 872615
Fax 051 872181
e-mail info@hwl.ie
web-site www.hwl.ie

SIENA

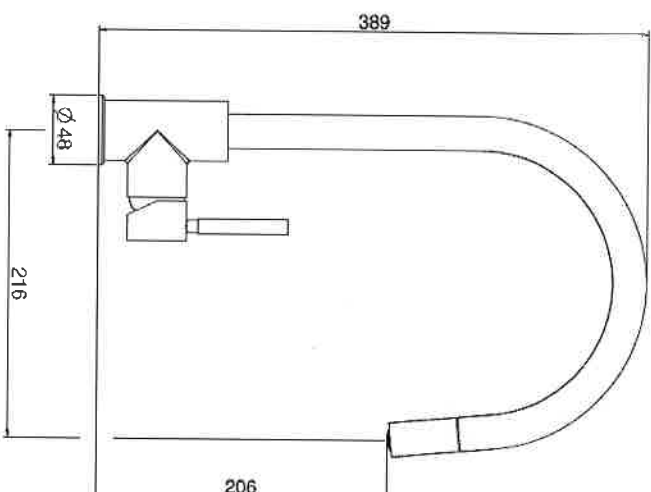

Fitting Instructions & Contents List

Please keep these instructions for future reference and request of replacement parts.

Please read these instructions before you install and use the tap. All designs, descriptions and dimensions are subject to change without notice.

Preparation

Flush the plumbing system before installing the mixer tap. This is to avoid plumbing residues clogging the mesh of the aerated outlet, or possibly damaging the valve's washers. This is especially important where extensive plumbing work has been carried out.
 First shut off your water heating system then, with your mains stop cock closed, open the lowest hot and cold taps in the house and allow to run until the cold storage tank and pipes are empty. (The hot water storage cylinder always remains full).

Installation

- First screw the threaded rod and screws into the mixer body. Screw the copper tubes into the mixer body, and fully hand tighten.
- Slide the plinth over the tails and flexible pipe on to the base of the tap.
- Pass the copper tubes, flexible pipe and threaded rod through the sink top from above, and place the mixer in position on the sink
- Slide the nylon bracing plate up to underside of the sink together with the C-plate rubber washer and retaining plate and secure by screwing the fixing nut finger tight. Check that the mixer body and plinth are correctly positioned and fully tighten fixing nut..

- Connect the flexible pipe to the threaded rod with washer provided
- Fix the load weight to the flexible pipe
- Connect the hot and cold supplies
- Having first checked all new connections, turn on the mains stop cock, close all taps except the new mixer and as the system starts to refill check for leaks.

It's recommended that Irish standard 1/2" fitting be used to connect mixer to supply pipes. The copper tailpipes comply with Irish Standard I.S.238.1980, i.e. they are 1/2" inch (14.7 mm)

CODE	DESCRIPTION
SP4073	Antisplash
SP4075+color	Spout
SP4076+color	Pull-out
SP3891	O-ring kit
SP1266+color	Handle
SP3692+color	Collar
SP4001	Brass Bush
SP1202	Cartridge
SP3734+color	Plinth
SP3931	Fixing Kit
SP4077	Flexi-tail
SP3616	Tail pipes
SP3946	Weight

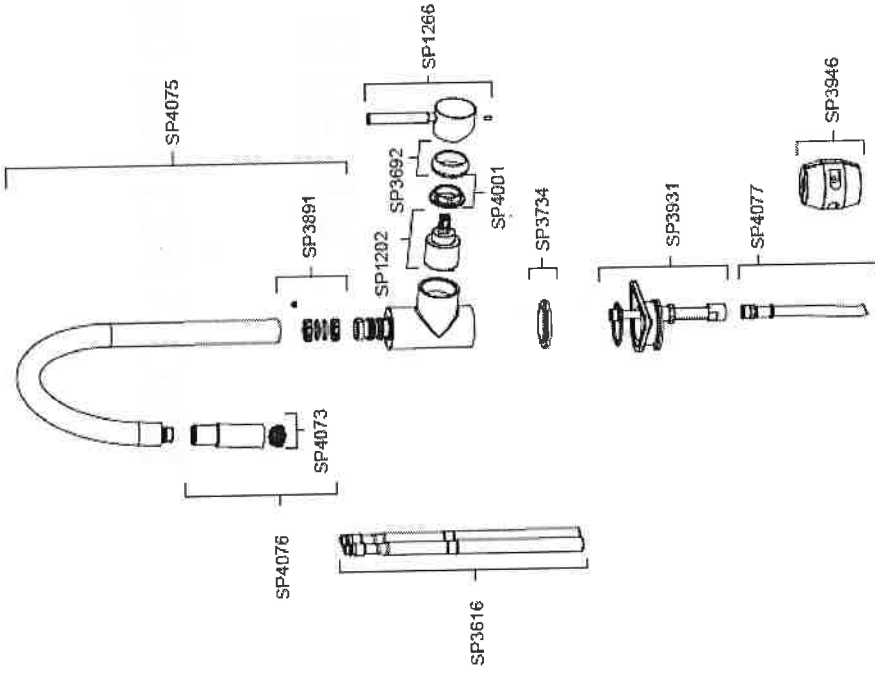

In the unlikely event you find a part missing please contact Highway Wholesalers Ltd. on 051 872615 for immediate dispatch of part.

Maintenance:

Where an aerator is fitted to the outlet of the spout, it will need occasional cleaning. This will be evident when the water flow slows down to an unacceptable level. To accomplish this unscrew the outlet in an anti-clockwise direction and remove the mesh. Immerse the mesh in a suitable descaling fluid overnight, rinse thoroughly in clean water and re-install.

Remember:

- Maximum water supply pressure: 75 PSI (5 bar)
- Maximum hot-water supply temperature: 70 °C
- Recommended hot-water supply temperature: 65 °C

If these temperatures or water pressure are exceeded damage to the tap can result. A pressure reducing valve may be required to be fitted in high water pressure situations.